

**Penntex** INDUSTRIES, INC. DATE: 03-11-10  
DRAWING BY Dmc Scale: None  
REVISED BY DATE:

**PX-8 ALTERNATOR**



**PX-8**  
**PARTS LIST**  
All

No.	Part #	Description	Qty.
1	PX-8400	Nut, Rotor Shaft (PX8)	1
2	PX-8261	Washer, Rotor Shaft Nut (PX8)	1
	N/A	Pulley, PX8 (Not Supplied)	0
4	PX-8440	Fan, Cooling (PX8)	1
5	PX-8058	Fan Shroud (PX8)	1
6	PX-8423	Washer, DE Frame Screw Lock	35
7	PX-8336	Bolt, Attach, For Shroud/Cover/Etc.	35
8	PX-8263	Screw, Bearing Retainer Plate	12
9	PX-8310	Retainer, Outside DE Bearing	1
10	PX-8138	Bearing, Outer (PX8)	1
11	PX-8129	Bolt, Frame Attachment	12
12	PX-8307	Housing, Front (PX8)	1
13	PX-8056	Spacer, Bearing (PX8)	1
14	PX-8878	Bearing, Inner DE (PX8)	1
15	PX-8060	Retainer, Inner DE Bearing (PX8)	1
16	PX-8315	Rotor, 28V (PX8)	1
17	PX-8614	Coil Assembly, Field (PX8)	1
18	PX-8249	Bushing, Fld. Term. Ins. (PX8)	3
19	PX-8568	Stator, 28V 330A (PX8)	1
20	PX-8051	Washer, Ins. Stator Term. (PX8)	3
21	PX-8611	Housing, Rear (PX8)	1
22	PX-1115	Washer, 3/8" Lock	14
23	PX-8191	Bolt, Fld. Coil Attachment (PX8)	4
24	PX-8193	Stud, Rectifier Bracket (PX8)	3
25	PX-8212	Bushing, Ins. Stator Term. (PX8)	3
26	PX-8805	Washer, Plain Stator Lead (PX8)	3
27	PX-8224	Nut, Stator & Diode Lead (PX8)	9
28	PX-8867	Diode Assembly (PX8)	6
29A	PX-8036A	Heat Sink, Rectifier Left (PX8)	1
29B	PX-8036B	Heat Sink, Rectifier Center (PX8)	1
29C	PX-8036C	Heat Sink, Rectifier Right (PX8)	1
30	PX-8711	Spacer, Rectifier Bracket (PX8)	3
31	PX-1098	Washer, #8 Flat	3
32	PX-1113	Nut, 10-32 Keps	3
33	PX-8148	Cover Plate, Rear (PX8)	1
34	PX-8039	Insulator, Sleeve Fld.&Relay Term.	6
35	PX-8746	Washer, Ins. Field Term. (PX8)	3
36	PX-1103	Washer, Fld/Rly Term, Shroud	9
37	PX-8326	Nut, Field & Relay Terminal	6
38	PX-8955	Terminal, Relay (PX8)	1

No.	Part #	Description	Qty.
39	PX-8209	Strap, Ground Field Term. (PX8)	1
40	PX-8055	Terminal, Ins. Sleeve (PX8)	2
41	PX-8246	Bushing, Ins. Output Term. (PX8)	1
42	PX-8038	Stud, Output Terminal (PX8)	1
43	PX-8813	Washer, Ins. Output Term. (PX8)	1
44	PX-8205	Washer, Plain Output (PX8)	1
45	PX-1252	Washer, 1/2" Split Lock Gr8	2
46	PX-8967	Nut, 5/16" Thick Jamb, Output Post (PX8)	1
47	PX-8548	Nut, 1/2" Thick, Output Post (PX8)	1
48	PX-8194	Kit, Stator Assembly Plug	1
49	PX-8150	Kit, Cable Support (positive only)	1
50	PX-8968	Kit, Pos/Negative Cable Support Kit	1
51	PX-8999	Bolt, Ground (PX8)	1
52	PX-1382	Washer, Flat 3/8"	1
NOTE: A PX-8 Alternator uses the existing Regulator and Harness.			
Contact Us: Phone: 817-590-2818 Fax: 817-590-0505 web: <a href="http://www.penntexusa.com">www.penntexusa.com</a> email: <a href="mailto:sales@penntexusa.com">sales@penntexusa.com</a>			
PennTex 06-30-2010			

21	PX-8611	Housing, Rear (PX8)	1
22	PX-1115	Washer, 3/8" Lock	14
23	PX-8191	Bolt, Fld. Coil Attachment (PX8)	4
24	PX-8193	Stud, Rectifier Bracket (PX8)	3
25	PX-8212	Bushing, Ins. Stator Term. (PX8)	3
26	PX-8805	Washer, Plain Stator Lead (PX8)	3
27	PX-8224	Nut, Stator & Diode Lead (PX8)	9
28	PX-8867	Diode Assembly (PX8)	6

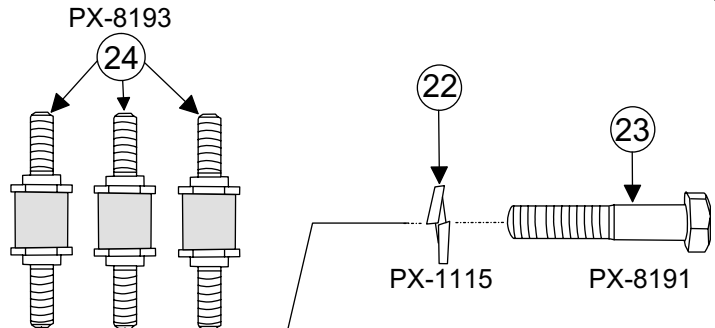

DON'T OVERTIGHTEN AS THE INSULATORS CAN SEPERATE

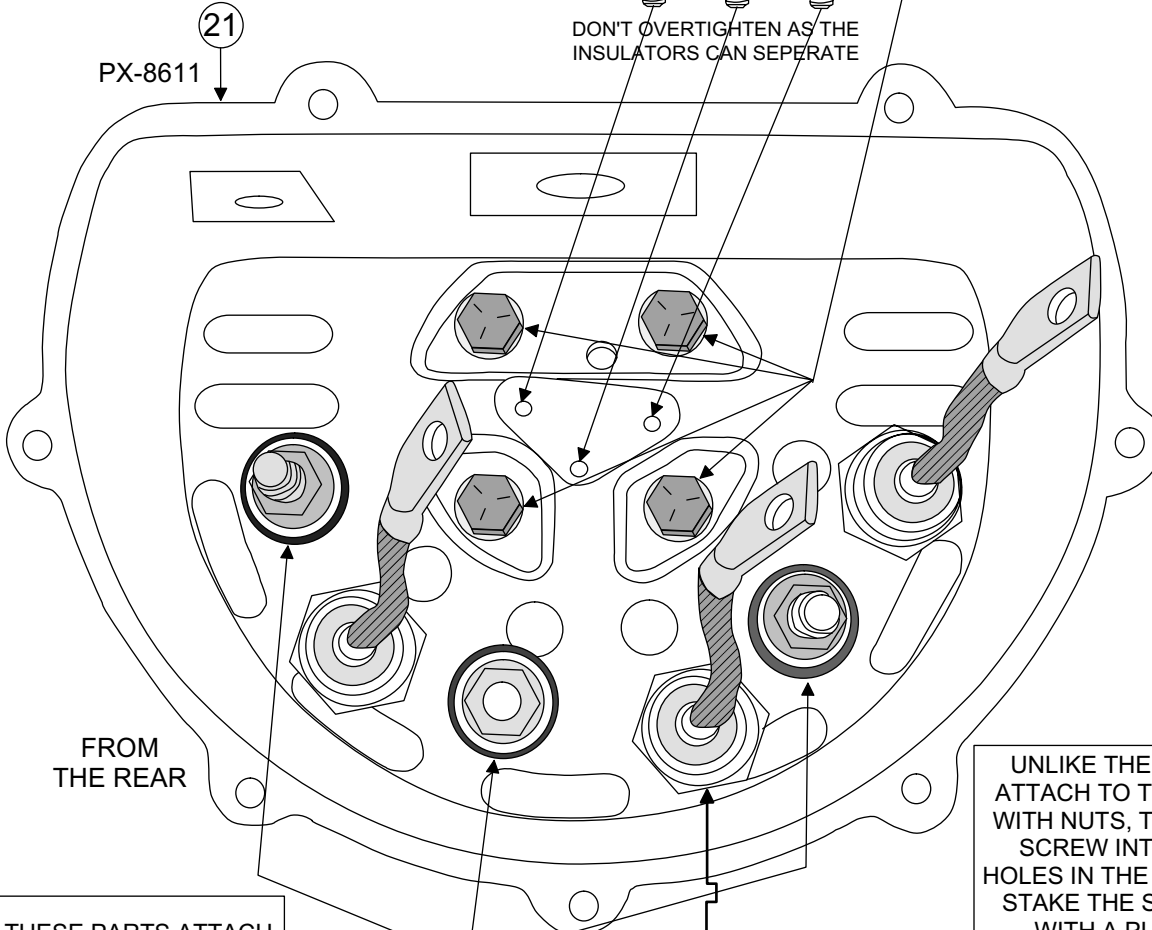

UNLIKE THE DIODES THAT ATTACH TO THE HEAT SINKS WITH NUTS, THESE 3 DIODES SCREW INTO THREADED HOLES IN THE REAR HOUSING. STAKE THE STUD THREADS WITH A PUNCH AFTER INSTALLATION TO KEEP THE DIODE IN PLACE.

THESE PARTS ATTACH THE STATOR LEADS TO THE CASE AND THE HEAT SINKS FOR THE POSITIVE DIODES MOUNT ON THE STUDS

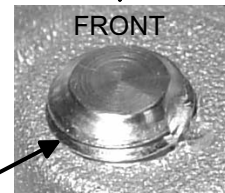
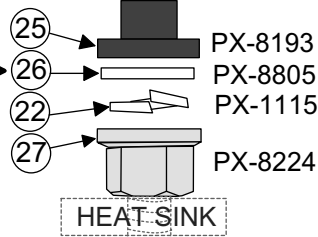

-ALL 6 DIODES ARE THE SAME- WHERE THEY MOUNT DETERMINES IF POSITIVE (HEAT SINK) OR NEGATIVE (REAR HOUSING)

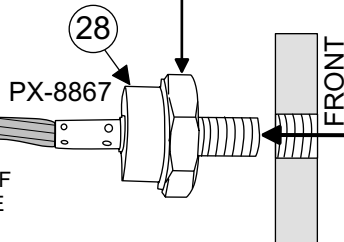

**Penntex**  
INDUSTRIES, INC. Date: 03-10-2009  
DRAWING BY DMC Scale: None  
REVISED BY DATE:

**PX-8 Rear Housing Hardware**

26	PX-8805	Washer, Plain Stator Lead (PX8)	3
27	PX-8224	Nut, Stator & Diode Lead (PX8)	9
28	PX-8867	Diode Assembly (PX8)	6
29A	PX-8036A	Heat Sink, Rectifier Left (PX8)	1
29B	PX-8036B	Heat Sink, Rectifier Center (PX8)	1
29C	PX-8036C	Heat Sink, Rectifier Right (PX8)	1
30	PX-8711	Spacer, Rectifier Bracket (PX8)	3

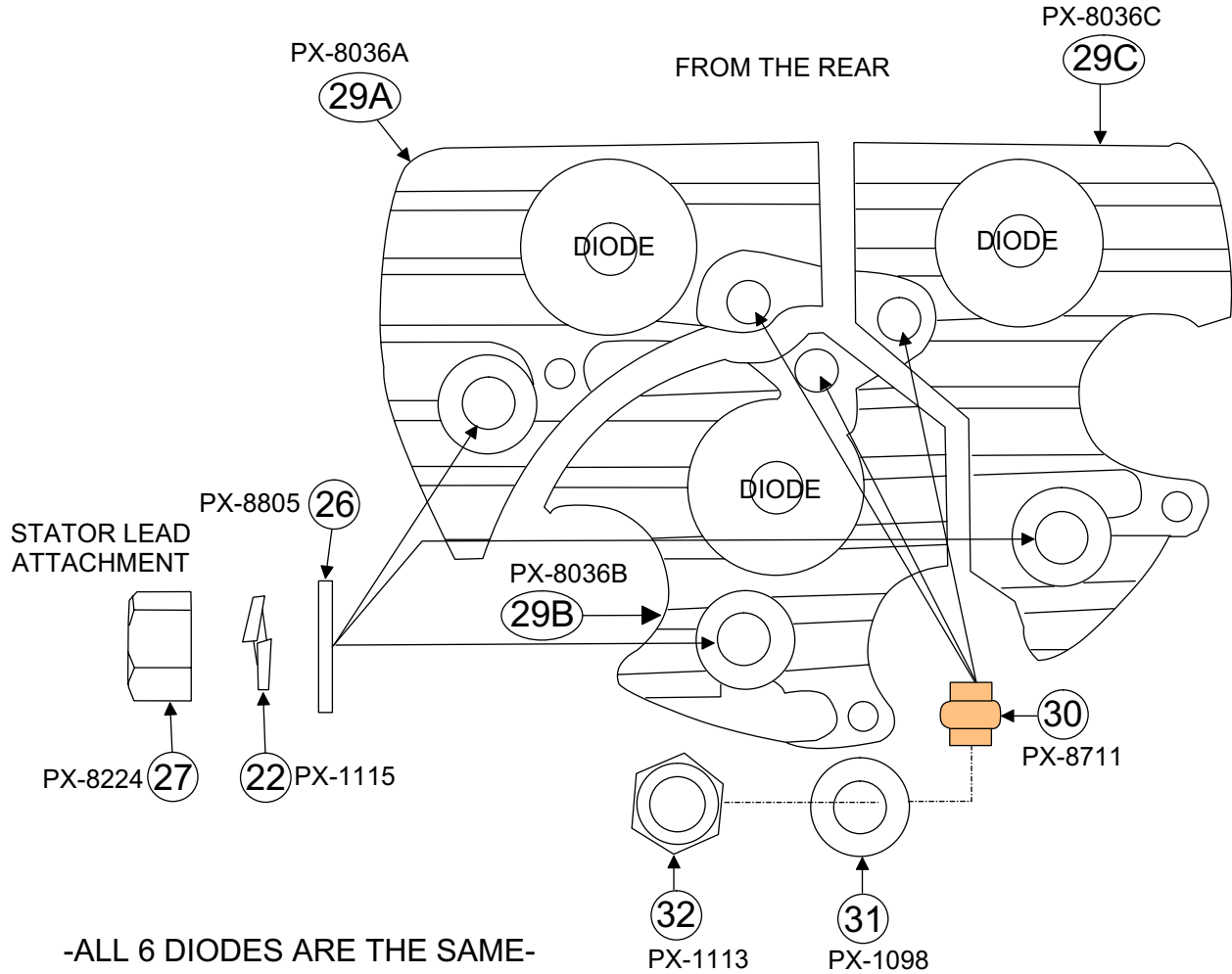

-ALL 6 DIODES ARE THE SAME-  
WHERE THEY MOUNT DETERMINES IF  
POSITIVE (HEAT SINK) OR NEGATIVE (CASE)

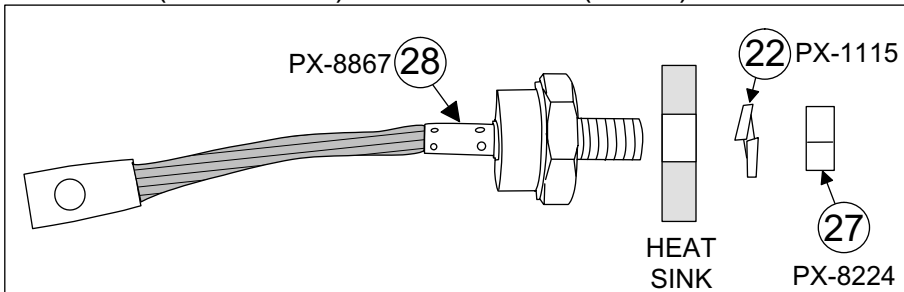

**Penntex**  
INDUSTRIES, INC.  
DRAWING BY DMc  
REVISED BY

Date: 03-11-2009  
Scale: None  
DATE:

**PX-8 Heat Sink Hardware**